

DX351

Version:00
Date:200117

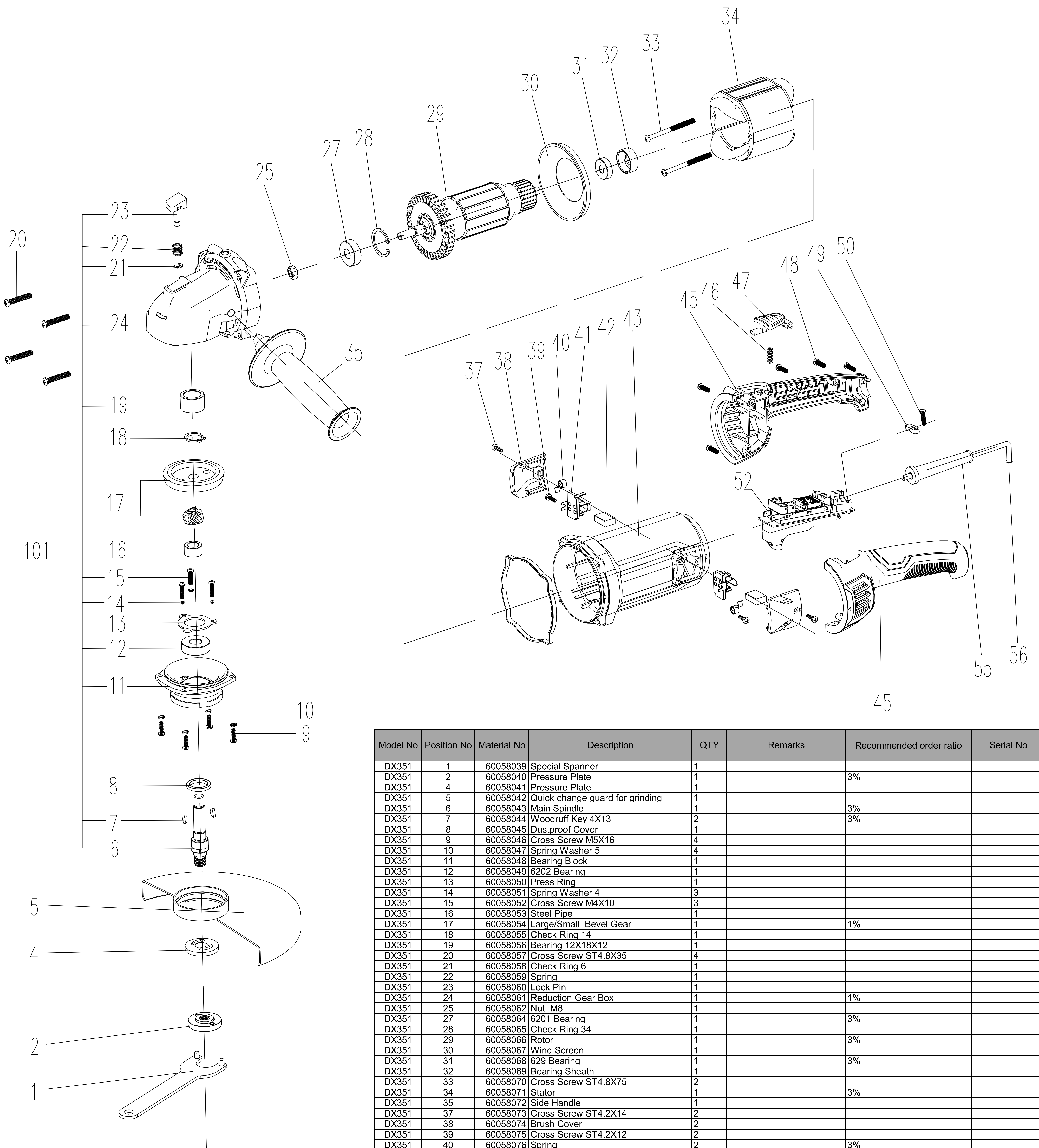

| Model No | Position No | Material No | Description | QTY | Remarks | Recommended order ratio | Serial No |
|----------|-------------|-------------|---------------------------------|-----|--------------------|-------------------------|-----------|
| DX351 | 1 | 60058039 | Special Spanner | 1 | | | |
| DX351 | 2 | 60058040 | Pressure Plate | 1 | | 3% | |
| DX351 | 4 | 60058041 | Pressure Plate | 1 | | | |
| DX351 | 5 | 60058042 | Quick change guard for grinding | 1 | | | |
| DX351 | 6 | 60058043 | Main Spindle | 1 | | 3% | |
| DX351 | 7 | 60058044 | Woodruff Key 4X13 | 2 | | 3% | |
| DX351 | 8 | 60058045 | Dustproof Cover | 1 | | | |
| DX351 | 9 | 60058046 | Cross Screw M5X16 | 4 | | | |
| DX351 | 10 | 60058047 | Spring Washer 5 | 4 | | | |
| DX351 | 11 | 60058048 | Bearing Block | 1 | | | |
| DX351 | 12 | 60058049 | 6202 Bearing | 1 | | | |
| DX351 | 13 | 60058050 | Press Ring | 1 | | | |
| DX351 | 14 | 60058051 | Spring Washer 4 | 3 | | | |
| DX351 | 15 | 60058052 | Cross Screw M4X10 | 3 | | | |
| DX351 | 16 | 60058053 | Steel Pipe | 1 | | | |
| DX351 | 17 | 60058054 | Large/Small Bevel Gear | 1 | | 1% | |
| DX351 | 18 | 60058055 | Check Ring 14 | 1 | | | |
| DX351 | 19 | 60058056 | Bearing 12X18X12 | 1 | | | |
| DX351 | 20 | 60058057 | Cross Screw ST4.8X35 | 4 | | | |
| DX351 | 21 | 60058058 | Check Ring 6 | 1 | | | |
| DX351 | 22 | 60058059 | Spring | 1 | | | |
| DX351 | 23 | 60058060 | Lock Pin | 1 | | | |
| DX351 | 24 | 60058061 | Reduction Gear Box | 1 | | 1% | |
| DX351 | 25 | 60058062 | Nut M8 | 1 | | | |
| DX351 | 27 | 60058064 | 6201 Bearing | 1 | | 3% | |
| DX351 | 28 | 60058065 | Check Ring 34 | 1 | | | |
| DX351 | 29 | 60058066 | Rotor | 1 | | 3% | |
| DX351 | 30 | 60058067 | Wind Screen | 1 | | | |
| DX351 | 31 | 60058068 | 629 Bearing | 1 | | 3% | |
| DX351 | 32 | 60058069 | Bearing Sheath | 1 | | | |
| DX351 | 33 | 60058070 | Cross Screw ST4.8X75 | 2 | | | |
| DX351 | 34 | 60058071 | Stator | 1 | | 3% | |
| DX351 | 35 | 60058072 | Side Handle | 1 | | | |
| DX351 | 37 | 60058073 | Cross Screw ST4.2X14 | 2 | | | |
| DX351 | 38 | 60058074 | Brush Cover | 2 | | | |
| DX351 | 39 | 60058075 | Cross Screw ST4.2X12 | 2 | | | |
| DX351 | 40 | 60058076 | Spring | 2 | | 3% | |
| DX351 | 41 | 60058077 | Brush Holder | 2 | | 3% | |
| DX351 | 42 | 60058078 | Carbon Brush(pair) | 1 | | 5% | |
| DX351 | 43 | 60058079 | Housing | 1 | | | |
| DX351 | 45 | 60058080 | Left/Right Handle | 1 | | | |
| DX351 | 46 | 60058081 | Spring | 1 | | | |
| DX351 | 47 | 60058082 | Pushbutton | 1 | | | |
| DX351 | 48 | 60058083 | Cross Screw ST4.2X18 | 5 | | | |
| DX351 | 49 | 60058084 | Cable Clip | 1 | | | |
| DX351 | 50 | 60058085 | Cross Screw ST4.2X16 | 1 | | | |
| DX351 | 52 | 60058086 | Switch&Capacitor | 1 | | 3% | |
| DX351 | 55 | 60058087 | Cord Protector | 1 | | | |
| DX351 | 56 | 60066332 | Power Cord | 1 | for AE-BS | 1% | |
| DX351 | 56 | 60066331 | Power Cord | 1 | for AE-VDE | 1% | |
| DX351 | 56 | 60067003 | Power Cord | 1 | for EU | 1% | |
| DX351 | 56 | 60068663 | Power Cord | 1 | for RU | 1% | |
| DX351 | 56 | 60058151 | Power Cord | 1 | for BR,PY,PE,CL,UY | 1% | |
| DX351 | 56 | 60064756 | Power Cord | 1 | for CN | 1% | |
| DX351 | 56 | 60064757 | Power Cord | 1 | for AR | 1% | |
| DX351 | 101 | 60074829 | Fore Housing Unit | 1 | | 1% | |